

# ACCURATE

Heavy Equipment Attachments & Guarding

## HYDRAULIC QUICK COUPLER (GENERIC)

(Anatomy)

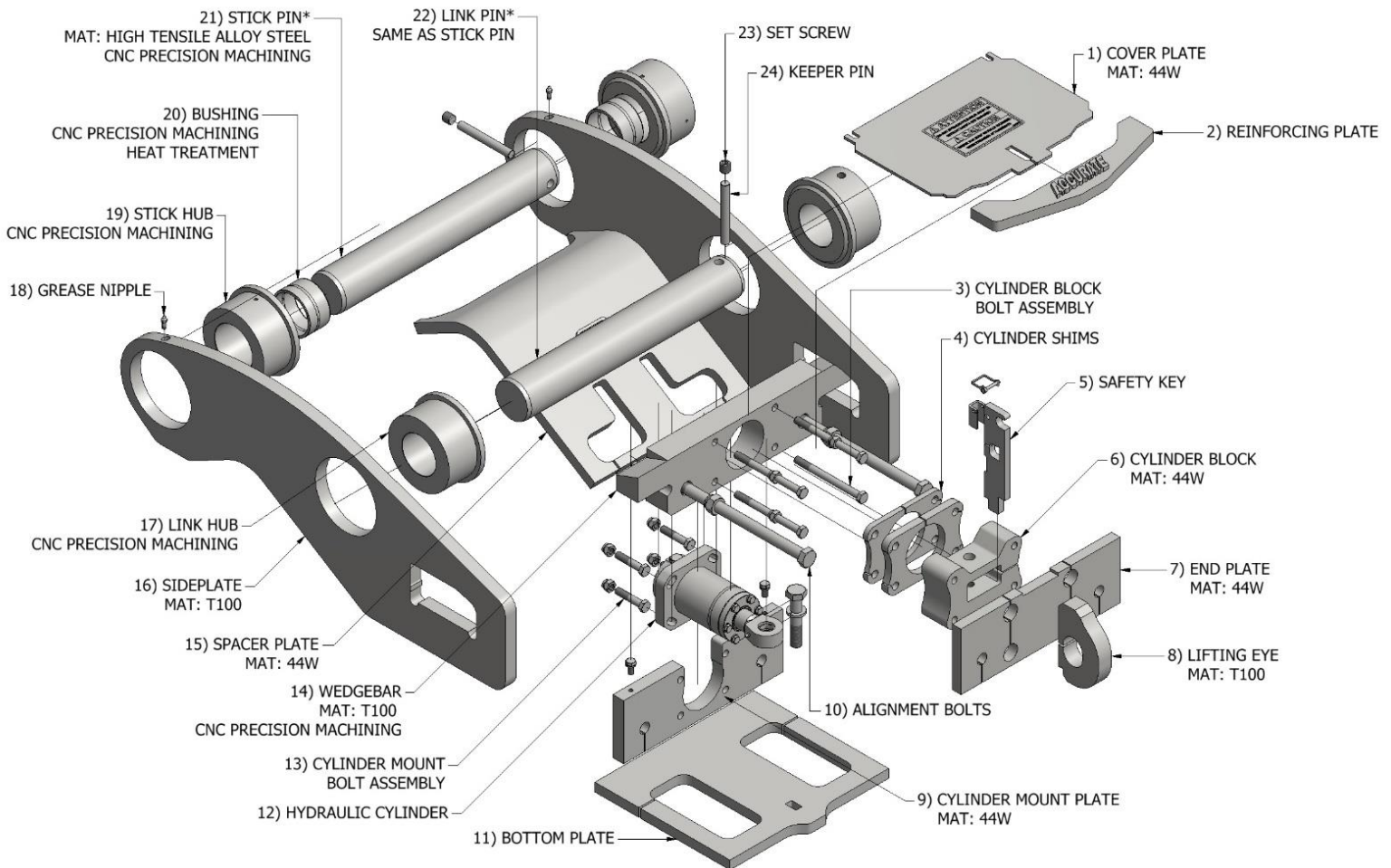

\*Pins are not required for all OEM machine manufacturers.

ACCURATE

# ***ACCURATE***

## **Heavy Equipment Attachments & Guarding**

---

Accurate Fabricating's heavy duty hydraulic wedge coupler is a universal (generic) design specific to each OEM machine of the same weight class, enabling the hookup to be one size fits all, dependable and easy to operate, with multiple safety systems incorporated. The coupler offers long life greasable bushings, coupled with heavy duty construction utilizing high grade T100,000 psi steel.

### **Features**

- WorkSafe compliant safety system – audible, cylinder lock valve, and manual safety pin
- Constant pressure load holding valve
- Full system pressure release
- Warning indicator for the operator in cab, when the wedgebar is disengaged
- Replaceable and greasable bushings to combat superficial arm pin wear
- Use of T100 steel (100000 psi) for sideplates and wedgebar
- Open-bottom frame allowing loose material and debris to exit the cylinder area easily
- Engineered and certified lifting eye
- Use of double barrel design for the cylinder
- Reverse-mounted cylinder resulting in compact design and reduced chance of damage
- Visual cylinder stroke travel indicator, assisting awareness to superficial attachment connection

### **Benefits:**

- Universal hook up, allowing reduced attachment inventory for end users operating a variety of OEM machines in the same weight class
- Easy introduction of thumbs that come with full floating or fixed pins
- No springs required on wedgebar guide bolts
- Available for full range of machine classes up to 90 T

### **Performance:**

- The hydraulic coupler's hubs and wedgebar long life performance, exceeds expectations when used with attachment lugs with fully machined contact points. (front saddle, rear saddle, and wedgebar surface)

